

RENTAL THE AKADEMIE

The place for
successful events

The word "AKADEMIE" is displayed in large, dark, three-dimensional block letters mounted on a light-colored concrete wall. The wall is composed of large rectangular panels separated by vertical and horizontal lines. In the foreground, the dark, shadowed silhouette of a tree or bush is visible on the right side of the wall.

AKADEMIE

THE AKADEMIE – THE PERFECT VENUE

Are you planning a function, professional course, general meeting, conference, seminar or a similar event and need a well-equipped venue?

Then look no further than the Akademie. Our venue features state-of-the-art infrastructure.



Here are just some of the benefits of the Akademie:

- The function room can be flexibly divided into areas of different sizes, and seating can be arranged to suit the nature of your event.
- The foyer and a spacious side room can be used for a coffee break, lunch or drinks reception – and can also be used in combination with an exhibition.
- The Akademie is in a central location with good public transport connections.
- SV (Schweiz) AG is on hand to provide refreshments for your guests. SV offers a wide range of healthy catering options that can be selected according to your wishes.



Take advantage of our professional team's experience and expertise, and the benefits of a well-equipped venue.

Our motivated team would be happy to assist you with planning your event and looks forward to receiving your inquiry.

Arrange a visit or a personal consultation today and lay the foundations for a successful event.



Claudia Gonzalez

Head of Empa-Akademie

Phone: +41 58 765 42 96

E-Mail: claudia.gonzalez@empa.ch



Our Akademie is equipped
with a hearing induction loop.

CAPACITY AND HIRE COSTS



Akademie

271 m²

CHF 3200.– 1 day

CHF 1900.– ½ day

Conference seating: 256 people

Seminar seating: 120 people

U-shape: 44 people

Area: 271 m²

Length: 18.80 m

Width: 14.40 m



Akademie I

162 m²

CHF 2200.– 1 day

CHF 1300.– ½ day

Conference seating: 108 people

Seminar seating: 60 people

U-shape: 24 people

Area: 162 m²

Length: 11.30 m

Width: 14.40 m



Akademie II

109 m²

CHF 1400.– 1 day

CHF 800.– ½ day

Conference seating: 56 people

Seminar seating: 40 people

U-shape: 22 people

Area: 108 m²

Length: 7.55 m

Width: 14.40 m

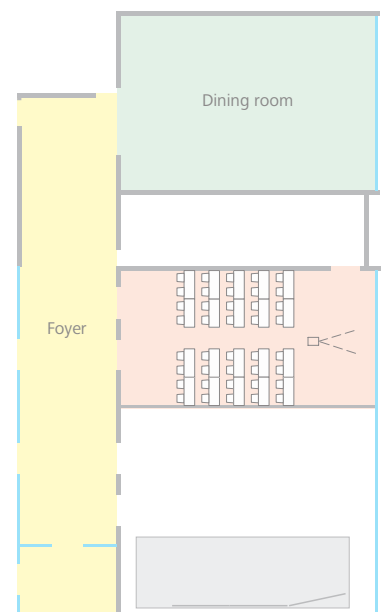
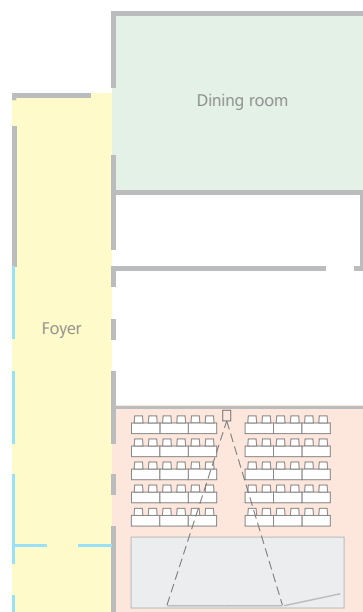
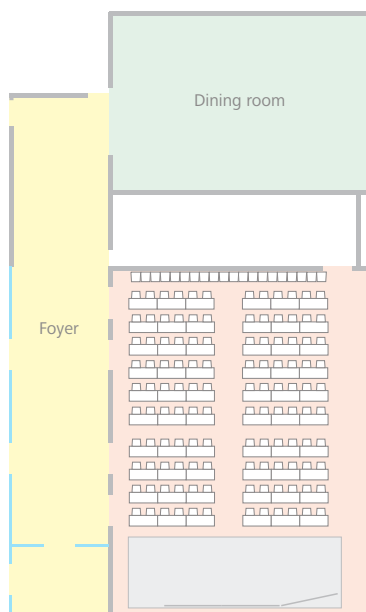

TECHNICAL EQUIPMENT, INFRASTRUCTURE AND EXHIBITION SITE PRICE LISTS



Included in the package price:

- Room rental, full day 8:00 to 18:00
- Room rental, half-day 8:00 to 13:00 / 13:00 to 18:00
- Access to the wireless network for all event participants
- Introduction to the AV technology (max. 30 minutes)
- Seating
- Electricity, heating/air conditioning
- 1 projector, 1 laptop with 1 laser pointer and projection screen

Only available at Akademie plenary or Akademie I

- Audio system with headsets and/or hand-held microphones
- Lectern
- Stage



Price list for additional technical equipment and infrastructure (per day)

Notebook	CHF 220.–
Screen (86-Inch)	CHF 500.–
Stand microphone	CHF 70.–
Video camera incl. camera operator	on request
Usage of Video-conferencing tool	on request
Facilitator's toolbox	CHF 40.–
Flip chart incl. 1 block, paper and pen	CHF 40.–
Pin board	CHF 40.–
Photocopies	CHF –.30/copy
Technical support	CHF 144.–/h
Project management and administrative support	CHF 133.–/h



Rental exhibition area

Exhibition area "Basic" (2 x 2 m) incl. 1 table, 2 chairs, 1 pin board, 1 power connector, Wireless network	CHF 400.–
Individual exhibition area	CHF 200.–/m ²
Large exhibition areas on request	

Rental charges outside normal operating hours

Before 8:00 or until 19:00	CHF 126.–/h
From 19:00	CHF 189.–/h
Weekends/public holidays	on request

CUSTOMER REVIEWS

We have been holding our symposium at the Akademie for 13 years because of the excellent architecture of the space and the perfect acoustics. It is easy to get to by private and public transport. And the "affordable" Hotel Sonnentel is within walking distance for overnight stays.

Dr Armin Ziegler, Ziegler Consultants

The Akademie is a fantastic venue and we will be happy to come back again in future.

Dr Christoph Quitmann, PSI

We greatly value the Empa-Akademie as a platform for the transfer of knowledge between research, development and practice. It is therefore the ideal partner for our main event, "Technology Days".

Isabella Friedrich, Swiss Engineering

MAP

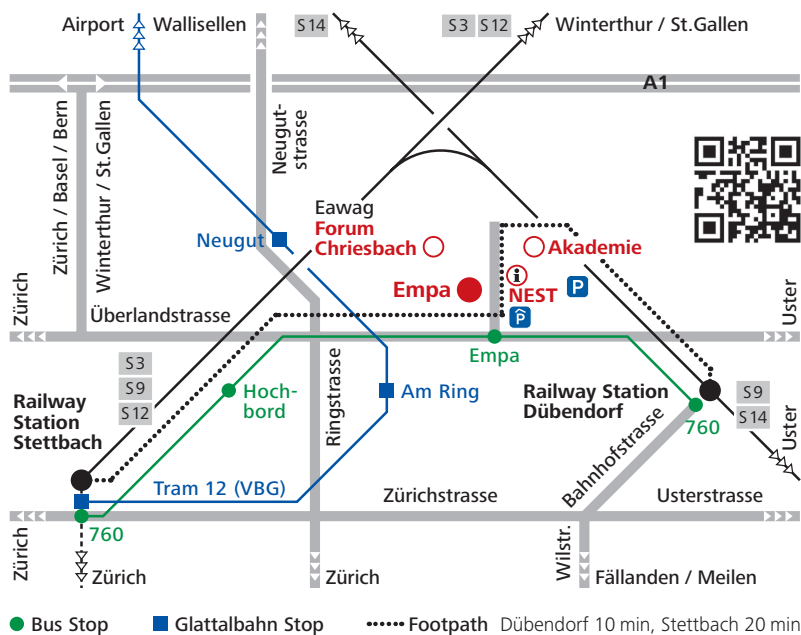

CONTACT

Claudia Gonzalez
 Head of Empa-Akademie
 Phone: +41 58 765 42 96
 E-Mail: claudia.gonzalez@empa.ch

events@empa.ch
empa-akademie.ch

